



EE&K a Perkins Eastman company

STREET SECTIONS

MASTER PLAN

6 EVARTS STREET: ROW HOUSES & GROCERY/MULTIFAMILY

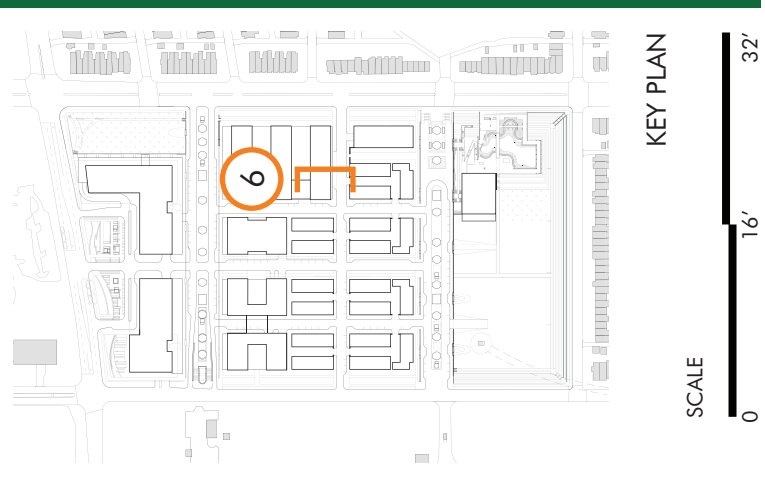

7 SOUTH SERVICE COURT: ROW HOUSES & COMMUNITY CENTER

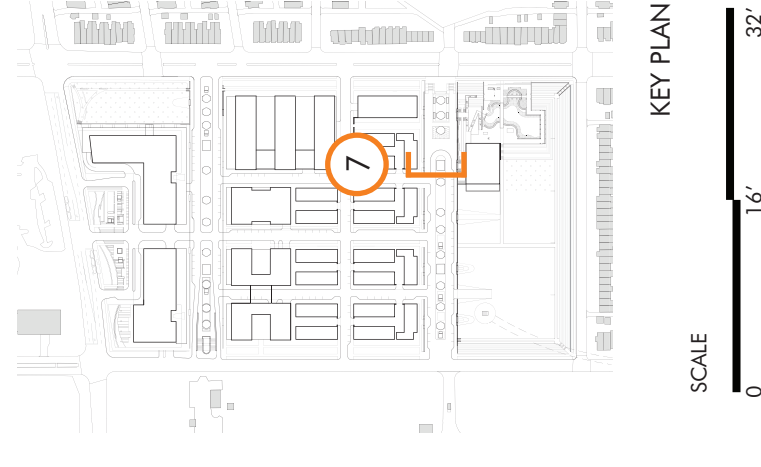



EE&K a Perkins Eastman company

STREET SECTIONS

MASTER PLAN

8 CHANNING STREET: PARK

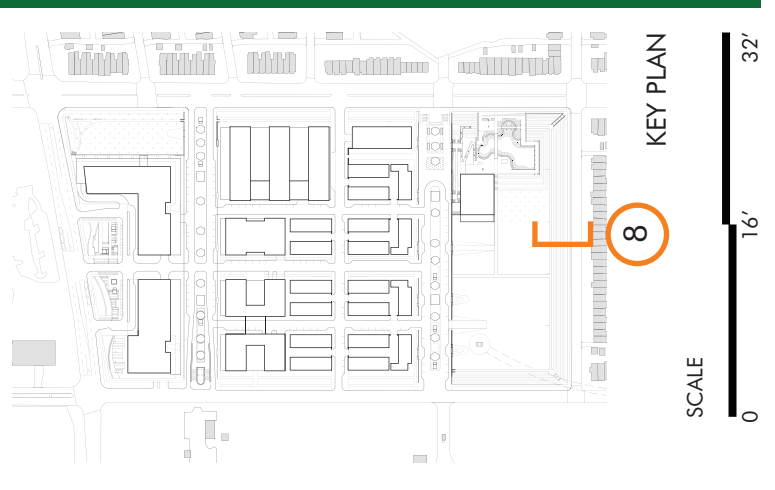
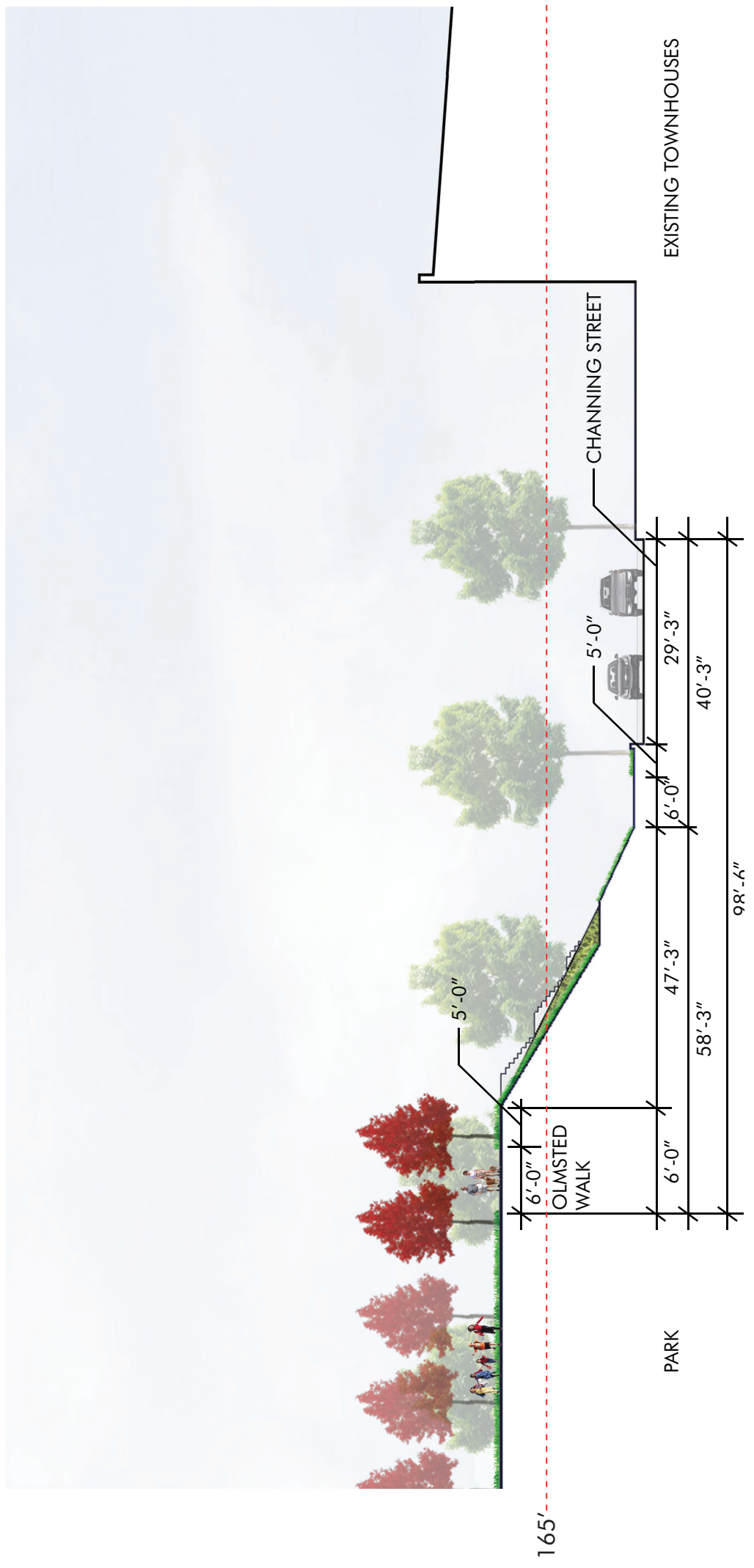

The public art program will distinguish McMillan as a destination, while referencing the important history of the site and reflecting the character of the surrounding community. Integrating public art into the redevelopment plan demonstrates Vision McMillan’s commitment to the community, as well as to the importance of creative place-making. McMillan’s public art program will strategically incorporate art installations that enhance the site’s community assets to be enjoyed by the public.

Public art will be incorporated into the overall lighting and landscape plan, with consideration for the site’s historical features, highlighting the importance of water, movement, recycled materials, and scale. Character-defining elements will serve as themes for the public artworks. Similarly, certain existing elements, such as the sand storage bins and regulator houses, will be developed with a public art objective.

The site’s historic character offers inspiration for public art themes including repetition and grids, the simple geometry of the cylindrical sand storage bins, cubic brick regulator houses, and pyramidal concrete washers. These key concepts will inform the selection and development process for public art on the site. Similarly, the public art team will consider potential synergies with the external viewpoints that connect neighborhood landmarks and points of city pride (i.e. Washington Monument; Basilica; Howard University’s Clock Tower).

In addition, the site’s functional elements, such as manhole covers, benches, pavers, and playground equipment, provide opportunities to include artists in the design, and in some cases, the fabrication of these objects. The public art program will be closely coordinated with the project’s design team to insure a cohesive approach that compliments the site’s architecture and landscape.

Public art will be integrated into the site in thoughtful innovative ways that define space, create a holistic art environment and make a strong aesthetic statement. The public art program will also draw attention to overlooked spaces, integrate artwork into the natural and built environment and evoke movement, whimsy, and character.



GOALS

Create a holistic, integrated art environment that makes a strong aesthetic statement

Activate space and functionality

Use public art to create an experience that references the historical significance of McMillan through content and/or materials

Highlight locations in innovative or unconventional ways

Enliven gathering locations where people could gravitate to and explore

Consider potential synergies with the external viewpoints that connect to neighborhood landmarks and points of city pride (i.e. Washington Monument; Basilica; Howard University's Clock Tower)

Design artworks to be distinctive yet complementary to both the historical assets and new development at McMillan

Consider key material features such as filter bed sand, iron in reference to the ironwork on portals and on manhole covers and other materials used throughout site: concrete, brick, clay, tile, wood and metal



Defining Place: Creating artist-designed gathering places



Reusing & Recycling Materials: Artists using historic and functional references by reusing materials

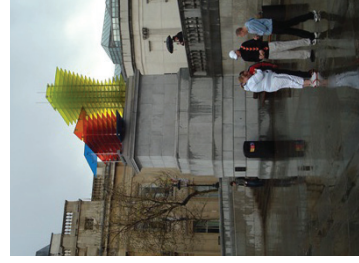

Dynamic Platforms for Contemporary Art: Creating spaces for rotating art installations



Integrated Streetscape Design: Functional design elements envisioned by artists



Discovering art in unexpected places...



...incorporating historic elements...



...drawing attention to overlooked spaces

KEY ELEMENTS

Water

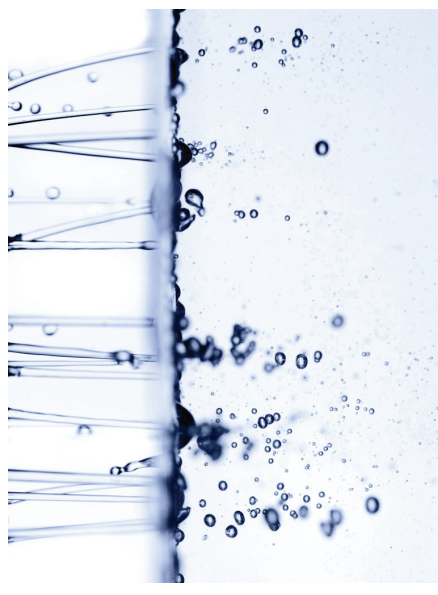

Sand



Earth



Concrete



OPPORTUNITIES FOR ARTISTIC INTERVENTION



- A. MAIN GATEWAY
- B. GATEWAY 2
- C. GATEWAY 3 (STAIRS)
- D. GATEWAY 4 (STAIRS)
- E. COMMUNITY CENTER
- F. REGULATOR HOUSE
- G. MANHOLE COVERS (CELLS 14 & 28)
- H. SAND STORAGE BINS/SILOS
- I. STATIONARY SAND WASHER
- J. PAVERS
- K. BENCHES/SEATING
- L. PLINTH AND/OR SCULPTURAL WORKS
- M. WATER THEMED ART INTEGRATED INTO DRAIN/BASIN INFRASTRUCTURE
- N. HEALING GARDENS
- O. OLMSTED UNDERPASS AND PEDESTRIAN AREA

NOTE: LOCATION OF ARTIST DESIGNED PAVERS (J) AND BENCHES/SEATING (K) PENDING FURTHER LANDSCAPE DESIGN DEVELOPMENT



Integrate artist-designed natural elements into main entrance to highlight 'sectional' theme of site